

Over All					
L1	L2	W1	W2	W3	W4
12.88	20.25	11.75	10.75	12.75	14.25

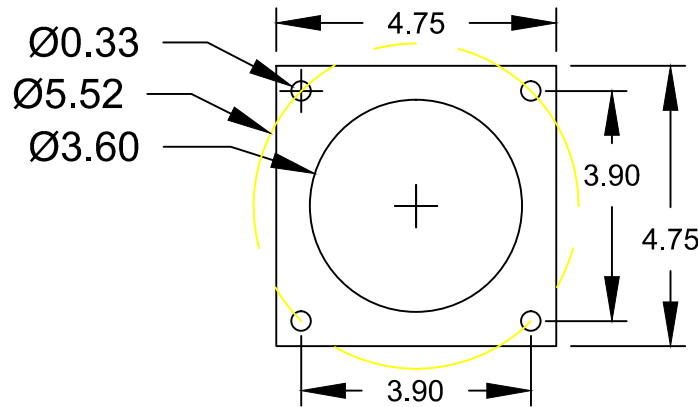

Power: 115/208-230/1/60  
208-230/460/3/60  
Amps: 6/3.2-3.3  
1-1.4/0.7  
Blower: 33 lbs  
Filter: 7 lbs  
CFM@ 0"(No Filter): 455

Filter Options:  
Pleated Paper 99.97% @ 1 Micron w/ Prefilter 10 micron provided  
Metal Mesh 60% @ AC Fine Dust.  
HEPA Filter with 99.997% @ 0.3 Microns Prefilter w/ Prefilter 10 micron provided

**WAYNE**  
PRODUCTS

888 Sussex Blvd. Broomall PA 19008  
800-255-5665 fax 610-251-0948

Model:  
Electra-Kool™ Model 500  
Filtered Ventilator System

date: 02/25/16	Size: A	Scale: NTS	dwg name: 500-3PP	REV
drawn by: MAF				sheet#